

1 2 3 4 5 6 7 8

REV	MODIFICATION	DATE	DRAW

F
E
D
C
B
A

F
E
D
C
B
A

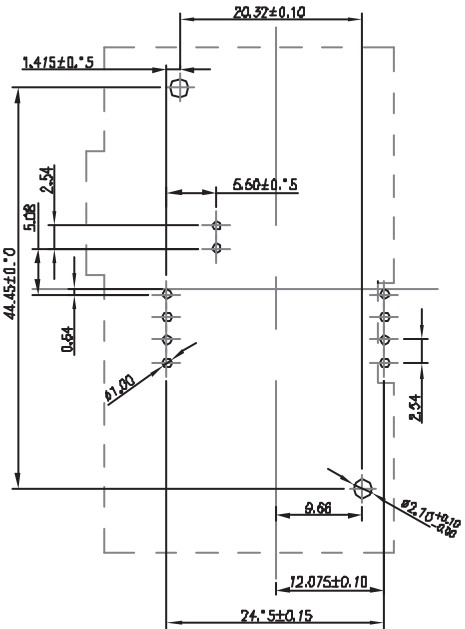
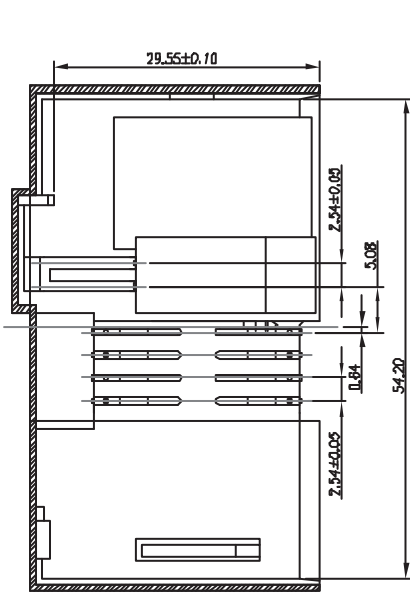
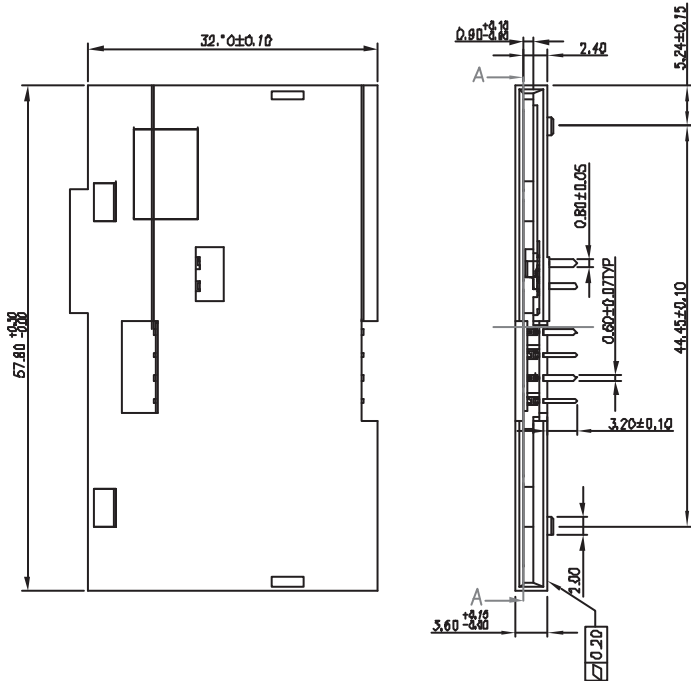
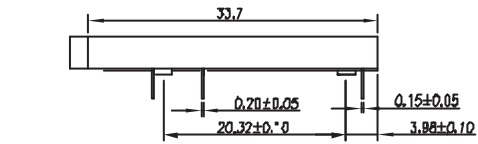

MATERIAL:
 COVER:THERMOPLASTIC, UL94V-0, BLACK
 HOSE:THERMOPLASTIC, UL94V-0, BLACK
 CONTACT:COPPER ALLOY, T=0.15mm
 SWITCH:COPPER ALLOY, T=0.20mm
 PLATING:
 CONTACT AREA-30u" GOLD OVER 50u" NICKEL
 RETENTION FORCE:0.30kg Min

ORDERING INFORMATION
 SMCRB-2 08 30 B102S
 PIN NO PLATING

DIMENSION IN mm [Inch]		PROD. SPEC.	ALMITA CO., LTD.	
TOLERANCE UNLESS OTHERWISE SPECIFIED		PKG. SPEC.	TITLE SCC LOW PROFILE DIP CUSTOMER DRAWING	
.X±0.30	X'±3'	APPROVE	FILE NO.	DWG NO. SMCRB-20830B102S
.XX±0.20	.X'±2'	CHECK	SIZE A4	PROJ. SHEET 1 / 1
.XXX±0.15	.XX'±	DRAW	SCALE 1.2:1	REV A

1 2 3 4 5 6 7 8 8F-01-R10