

PART NO. 007-01-00437

REVISIONS			
LTR	DESCRIPTION	Drawing	DATE
A	INITIAL FOR MANUFACTURE REL	BILL	07/06/07'
B	ADDITION THE VIEW AND DATE CODE	BILL	04/17/07'

CUSTOMER DRAWING

D
C
B
A

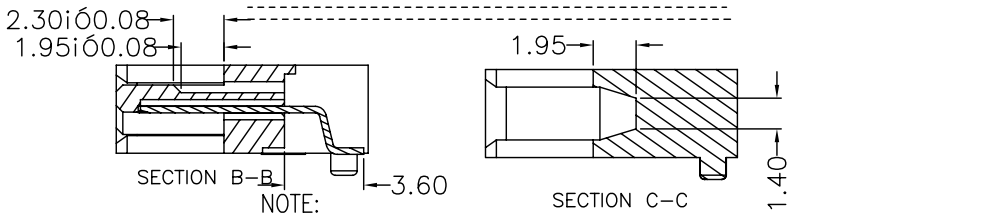
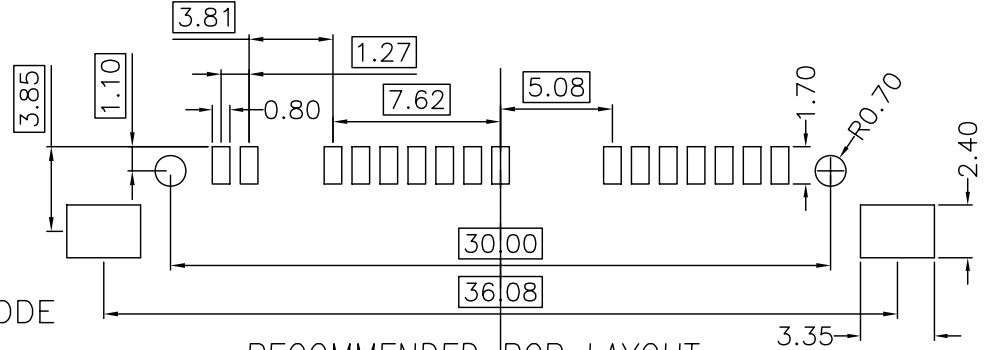
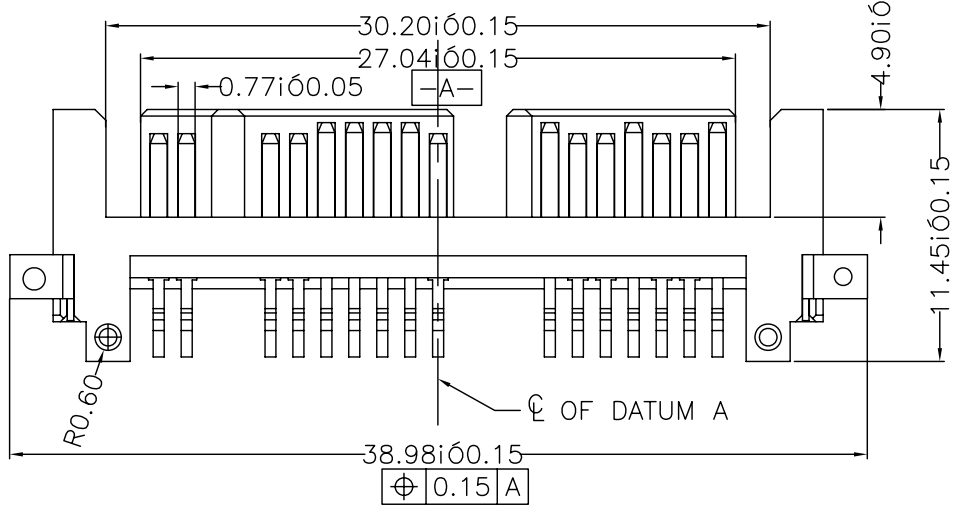
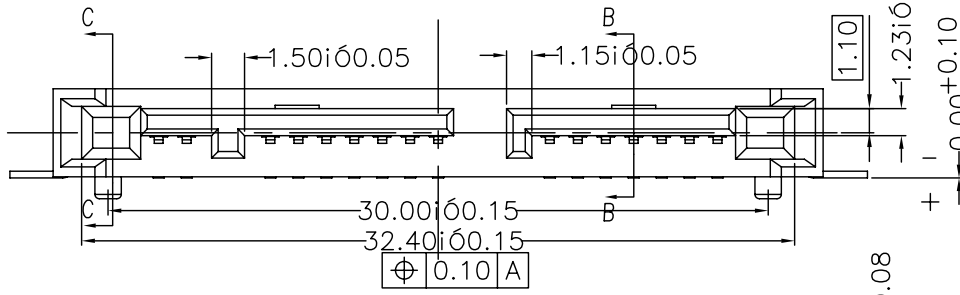
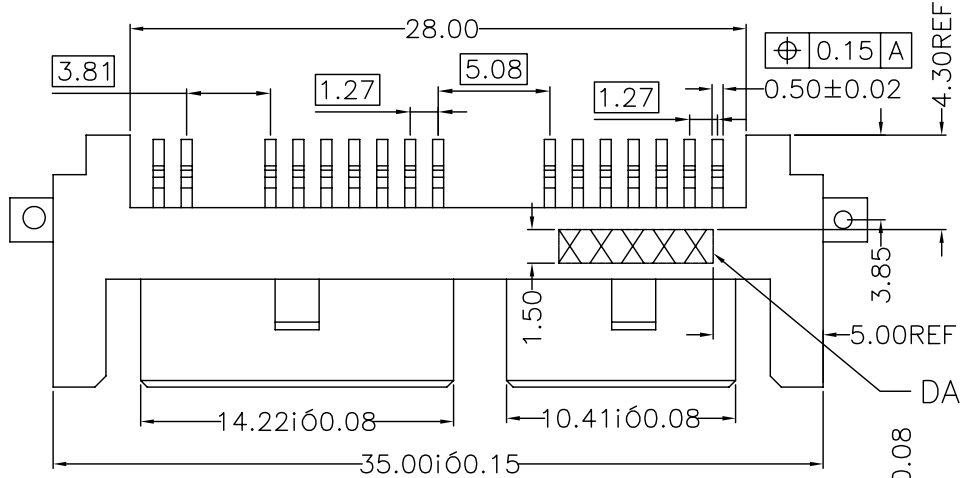

- NOTE:
 1.MATERIAL :
 BASE: HIGH THERMOPLASTIC UL94V-0, COLOR : BLACK
 TERMINAL: COPPER ALLOY, T= 0.30mm
 LATCH:BRASS,T= 0.30mm
 2,PLATING:
 CONTACT:GOLD PLATED ON THE CONTACT.
 MISTY TIN PLATED ON THE SOLDER TAIL.
 NICKEL UNDERPLATED OVER ALL.
 LATCH:MISTY TIN PLATED ON THE ALL SURFACE.
 NICKEL UNDERPLATED OVER ALL.
 3.ELECTRONICAL SPECIFICATION:
 CURRENT RATING: 1.5 AMPERE PER CONTACT
 CONTACT RESISTANCE: 30 MILLIOHMS MAX.
 INSULATION RESISTANCE: 1000 MEGOHMS MIN.
 DIELECTRIC WITHSTANDING VOLTAGE: 500 VAC.
 OPERATING TEMPERATURE: -40°C~+85°C
 4.THE PRODUCT SHOULD BE GP COMPLIANCE.

5.DATE CODE:
 XX XX X
 | | |
 DATE
 WEEK
 YEAR

DIMENSION ARE MILLIMETERS TOLERANCES ARE : DECIMALS .X ± 0.20 .XX ± 0.15 ANGLE: X ± 1'	APPROVALS		DATE	TITLE: SATA 16P PLUG SMT TYPE
	DRAWN	BILL	04/17/08	
	CHECKED			
	APPROVALS			
	SIZE mm	SCALE : 1 : 1	DRAWING NO. 000506	REV. B
	ID NO.	XXXXXXXXXX	SHEET 1 OF 1	

NO	DESCRIPTION	Q'TY	UNIT	DO NOT SCALE DRAWING
----	-------------	------	------	----------------------

4 3 2 1