

Multi Media Card Connector Without Cover Type

TL9000 IECQ TL9000 IECQ TL9000 IECQ TL9000 IECQ TL9000 IECQ TL9000 IECQ TL9000 IECQ TL9000

Part No:

SDAMB-00715B100

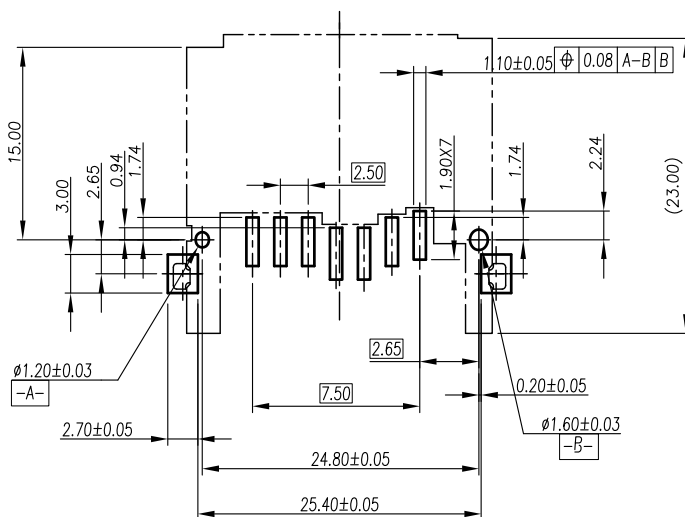
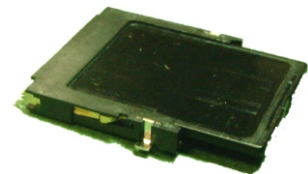
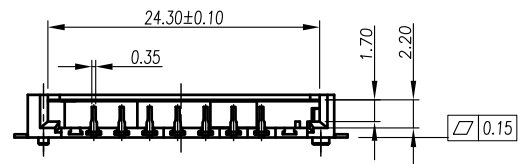
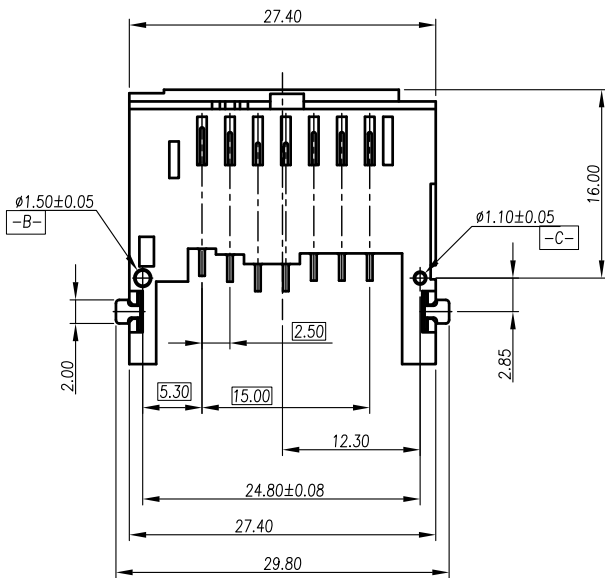
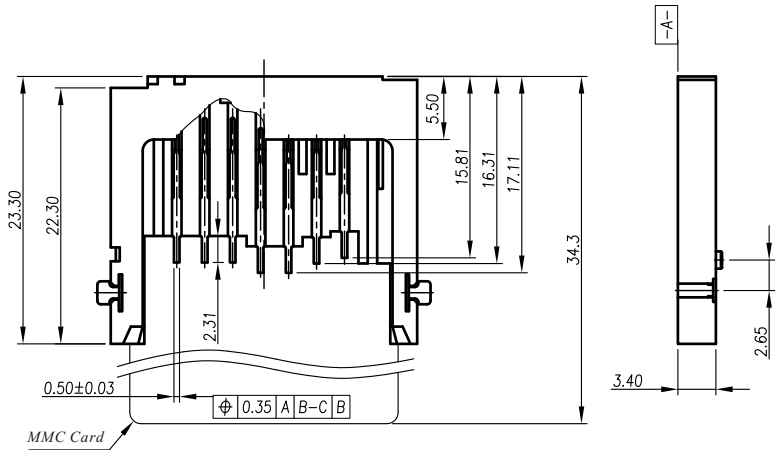
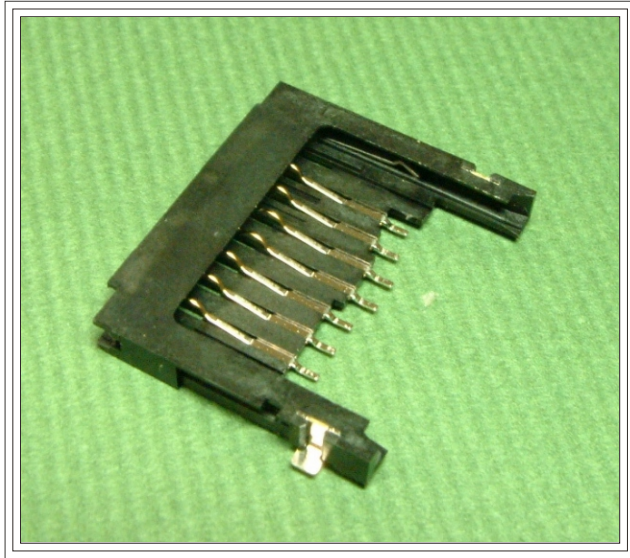

P.C.B Layout

Specification:

- Withstanding Voltage: 500V AC Max for 1 Minute
- Insulation Resistance: 1,000 M Ohms
- Voltage Rating: 250VAC
- Current Rating: 0.5A AC/DC Max
- Contact Resistance: 40M Ohms Max
- Operating Temperature: -25 C ~ +85 C
- Insertion Cycles: 10,000 Times

Application:

For Multi Media Card Use Only

Material And Finish:

- Contact: Copper Alloy
- Housing: LCP, Glass Fiber