

Section A-A

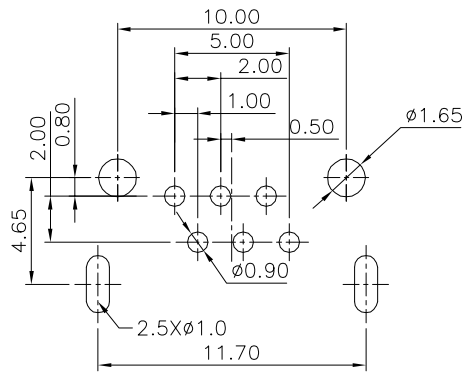

Recommended P.C.B Layout

Specifications:  
 Current rating:1.0A AC,DC  
 Voltage rating:30V AC, DC  
 Contact resistance:20m ohm Max  
 Insulation resistance:1000M ohm Min  
 Withstanding voltage:AC 750V AC/minute  
 Operating Temperature:-40°C ~ +105°C  
 Materials:  
 Insulator:High Temperature Plastic UL94V-0  
 Contact material:Copper Alloy  
 Contact Plated:Selective Gold Plated  
 Shell:Metal Iron with Nickel plated  
 How to Order  
 1394R-06-F1  
 Lead Free  
 No. Of Positions  
 Right Angle Type

RoHS Compliant

F				DRAWN:	GENERAL TOLERANCE:		
E				Cel King	.X=±0.20		
D				CHECKED:	.XX=±0.15		
C				Jeremy Liu	UNIT: MM	DESCRIPTION:	SIZE
B				APPROVAL:	SCALE: 1:1	IEEE 1394 Female 6P Right Angle Type	<b>A4</b>
A	15-Sep-2005	(PC0052)	Cel King	Mike Wu	SHEET: 1 / 1	PART NO:	
REV	DATE	FILE	BY		PROJECTION:	1394R-06-F1	

